



## Community Development Authority Priority Development Sites - 2007

Village of Shorewood  
3930 N. Murray Ave  
Shorewood, WI 53211  
414.847.2700

**Item**

**1 4525-4551 Oakland**

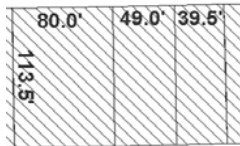

<p>a. <b>address</b> 4541 N. Oakland</p> <p><b>tax ID</b></p> <p><b>Owner:</b> Village of Shorewood</p> <p>3930 N. Murray Ave</p> <p><b>phone</b> 414.847-2700</p> <p><i>RFQ deadline December 5, 2006</i></p>	<p><b>current use</b> 3 vacant lots</p> <p><b>Zoning</b> B-2 Mixed Use</p> <p><b>Lot area</b> 168.5 x 113.5'</p> <p><b>building area</b> -</p> <p><b>number of stories</b> 2-4' allowable</p>	<p><b>land assessment 2006</b> \$1.3 ml</p> <p><b>building assessment 2006</b> -</p> <p><b>equalized value</b></p>
--	---	--

**2 Milwaukee River site**



<p>a. <b>address</b> 1111 E. Capitol</p> <p><b>tax ID</b> 2758993</p> <p><b>Business</b> Riverbrook Family Restaurant, 414.332.5155</p> <p><b>Company</b> BGA Partnership</p> <p><b>address</b> 1111 E. Capitol, Shorewood WI 53202</p> <p><b>Owner</b> George Panagiotopolous</p> <p><b>Phone</b></p>	<p><b>current use</b> restaurant</p> <p><b>Zoning</b> B-4 River District</p> <p><b>Lot area</b> 1.966 acres. 385'x82'x386'x148'x177'</p> <p><b>building area</b> -</p> <p><b>number of stories</b> 1</p>	<p><b>land assessment 2006</b> \$551,700</p> <p><b>building assessment 2006</b> <u>\$1,284,800</u></p> <p><b>Total assessment</b> \$1,836,500</p> <p><b>equalized value</b> \$2,705,510</p>
<p>b. <b>address</b> 3907 &amp; 3909 N. Sherburn Place</p> <p><b>tax ID</b> 2758992002</p> <p><b>Business</b></p> <p><b>Company</b></p> <p><b>address</b> 16620 Woods Edge CT, Brookfield WI 53005-3548</p> <p><b>Owner</b> John L. Toohey</p> <p><b>Phone</b></p>	<p><b>current use</b> 2 multifamily</p> <p><b>Zoning</b> B-4 River District</p> <p><b>Lot area</b> 1.484 acres. 390'x170'x328'x190'</p> <p><b>building area</b> -</p> <p><b>number of stories</b> 2</p>	<p><b>land assessment 2006</b> \$360,000</p> <p><b>building assessment 2006</b> <u>\$1,235,000</u></p> <p><b>Total assessment</b> \$1,595,000</p> <p><b>equalized value</b> \$2,349,735</p>
<p>c. <b>address</b> 3900 Sherburn Place</p> <p><b>tax ID</b> 2758991000</p> <p><b>Owner:</b> James Petr</p> <p>6203 W. Washington Blvd, Wauwatosa, WI 53213</p> <p><b>phone</b></p>	<p><b>current use</b> warehouse</p> <p><b>Zoning</b> B-4 River District</p> <p><b>Lot area</b> 5.696 acres. 1244'x115'x1200'x378'</p> <p><b>building area</b> -</p> <p><b>number of stories</b> 2</p>	<p><b>land assessment 2006</b> \$328,400</p> <p><b>building assessment 2006</b> <u>\$623,500</u></p> <p><b>Total assessment</b> \$951,900</p> <p><b>equalized value</b> \$1,402,328</p>



**Community Development Authority  
Priority Development Sites - 2007**

Village of Shorewood  
3930 N. Murray Ave  
Shorewood, WI 53211  
414.847.2700

**3 4027 Oakland Sendik's parking lots**



a.	<b>address</b>	4027 N. Oakland Ave	<b>current use</b>	parking lot		
	<b>tax ID</b>	2400025, 2400026	<b>Zoning</b>	B-1 Commercial	<b>land assessment 2006</b>	\$200,000
	<b>Company address</b>	Sendiks II LLC 11412 N. Port Washington Rd, ste 2026, Mequon WI 53092	<b>Lot area</b>	120 x 287'	<b>building assessment 2006</b>	<u>\$476,200</u>
	<b>Owner</b>	John Nehring	<b>building area</b>	-	<b>Total assessment</b>	\$676,200
	<b>phone</b>		<b>number of stories</b>	-	<b>equalized value</b>	\$996,170
			<b>LLC: ID S053854. Agent Joseph Balistreri ESQ</b>	1000 N. Water St Ste 2100 Milwaukee, WI 53202		

**4 3501 Oakland- River Park parking**



a.	<b>address</b>	3501 N. Oakland Ave 2758987-004,005,006,007; 2758985-001	<b>current use</b>	parking lot		
	<b>tax ID</b>	2758987-004,005,006,007; 2758985-001	<b>Zoning</b>	B-1 Commercial	<b>land assessment 2006</b>	
	<b>Company address</b>	Village Owned	<b>Lot area</b>	2 acres; 285 x 306'	<b>building assessment 2006</b>	
			<b>building area</b>	-	<b>Total assessment</b>	
			<b>number of stories</b>	-	<b>equalized value</b>	

**5 3600-3624 Oakland**



a.	<b>address</b>	3624 N. Oakland Ave	<b>current use</b>	gas station		
	<b>tax ID</b>	2760187	<b>Zoning</b>	B-2 Mixed Use Residential	<b>land assessment 2006</b>	\$233,000
	<b>Business Company address</b>	Oakland Amaco, 961-0012 BEG Enterprises FOUR LLC 2715 W. C ounty Club Dr, Mequon WI 53092	<b>Lot area</b>	116' x 124'	<b>building assessment 2006</b>	<u>\$112,700</u>
	<b>Owner</b>	Atlantic Richfield Co	<b>building area</b>	29' x 50'	<b>Total assessment</b>	\$345,700
	<b>phone</b>		<b>number of stories</b>	1	<b>equalized value</b>	\$509,281
			<b>LLC: ID B050055 Agent Kalim Mirza 2715 W. Country Club Dr, Mequon, WI 53092</b>			



## Community Development Authority Priority Development Sites - 2007

Village of Shorewood  
3930 N. Murray Ave  
Shorewood, WI 53211  
414.847.2700



<p><b>b.</b></p> <p><b>address</b> 3610 N. Oakland Ave.</p> <p><b>tax ID</b> 2760186000</p> <p><b>Business</b> office</p> <p><b>Company address</b> M.K.Field Six LLC 2412 E. Beverly Road, Shorewood, WI 53211</p> <p><b>Owner</b> Marshall and Ann Field</p> <p><b>phone</b></p>	<p><b>current use</b> office</p> <p><b>Zoning</b> B-2 Mixed Use Residential</p> <p><b>Lot area</b> 116' x 39'</p> <p><b>building area</b> 49' x 40'</p> <p><b>number of stories</b> 2</p> <p><b>LLC:</b> F035400 Agent Bruce Field 3610 N. Oakland Ave Shorewood WI 53211</p>	<p><b>land assessment 2006</b> \$71,100</p> <p><b>building assessment 2006</b> \$215,300</p> <p><b>Total assessment</b> \$286,400</p> <p><b>equalized value</b> \$421,921</p> <p><b>lessee</b> Arline Beauty Salon 414.332.6120</p> <p><b>business number</b> Edgewood Tailors and Furrier:414.332.2389</p> <p><b>lessee mailing address</b> Gardens by Garland 414.962.1602</p> <p>Pearl Communications 414.964.9119</p>
--	---	---

<p><b>c.</b></p> <p><b>address</b> 3600 N. Oakland Ave.</p> <p><b>tax ID</b> 2760185000</p> <p><b>Business</b> East Gardens Chinese Restaurant</p> <p><b>Company address</b> East Gardens LLC 3600 N. Oakland Ave. Shorewood, WI 53211-2234</p> <p><b>Owner</b> Sik Kin &amp; Wen Chen Ng</p> <p><b>phone</b></p>	<p><b>current use</b> restaurant</p> <p><b>Zoning</b> B-2 Mixed Use Residential</p> <p><b>Lot area</b> 116' x 85'</p> <p><b>building area</b> 65' x 73'</p> <p><b>number of stories</b> 1</p>	<p><b>land assessment 2006</b> \$162,300</p> <p><b>building assessment 2006</b> \$446,200</p> <p><b>Total assessment</b> \$608,500</p> <p><b>equalized value</b> \$896,435</p>
---	---	--

**6** 4144-4170 Oakland



<p><b>a.</b></p> <p><b>address</b> 1807-9 E. Olive St</p> <p><b>tax ID</b> 2390381</p> <p><b>Business</b> Capital 46 LLC</p> <p><b>Company address</b> 3287 N. Oakland Ave, Milwaukee WI 53211</p> <p><b>Owner</b> Eastmore Real Estate, Leonard Sobczak</p> <p><b>phone</b></p>	<p><b>current use</b> 12 unit multifamily</p> <p><b>Zoning</b> B-1 Commercial</p> <p><b>Lot area</b> 86' x 100'</p> <p><b>building area</b> 80' x 56'</p> <p><b>number of stories</b> 2</p> <p><b>LLC:</b> ID C061391 Agent Leonard Sobczak 3287 N Oakland Avenue Milwaukee WI 53211</p>	<p><b>land assessment 2006</b> \$160,000</p> <p><b>building assessment 2006</b> \$418,700</p> <p><b>Total assessment</b> \$578,700</p> <p><b>equalized value</b> \$852,534</p>
--	--	--



## Community Development Authority Priority Development Sites - 2007

Village of Shorewood  
3930 N. Murray Ave  
Shorewood, WI 53211  
414.847.2700



b.	<b>address</b>	4170 N. Oakland Ave.	<b>current use</b>	coffee shop		
	<b>tax ID</b>	2390380	<b>Zoning</b>	B-1 Commercial	<b>land assessment 2006</b>	\$106,000
	<b>Business</b>	Star Bucks	<b>Lot area</b>	50' x 100'	<b>building assessment 2006</b>	<u>\$50,800</u>
	<b>Company</b>	4170 N Oakland LLC	<b>building area</b>		<b>Total assessment</b>	\$156,800
	<b>address</b>	611 N. Bay Point Rd, Bayside, WI 53217	<b>number of stories</b>		<b>equalized value</b>	\$230,996
	<b>Owner</b>	Marion K Laev				
	<b>phone</b>					

c.	<b>address</b>	4156-4166	<b>current use</b>	office/food		
	<b>tax ID</b>	2390379	<b>Zoning</b>	B-1 Commercial	<b>land assessment 2006</b>	\$164,400
	<b>Business</b>		<b>Lot area</b>	11,550 sf	<b>building assessment 2006</b>	<u>\$488,000</u>
	<b>Company</b>	Palmetto LLC	<b>building area</b>	127' x 40'	<b>Total assessment</b>	\$652,400
	<b>address</b>	PO Box 11055 Shorewood, WI 53211	<b>number of stories</b>	1	<b>equalized value</b>	\$961,108
	<b>Owner</b>	Wendy Wasserman	<b>LLC: ID P037733 Agent Larry L Nifong 2131 S Webster Ave ste 201 Green Bay WI 54301</b>			
	<b>phone</b>		<b>lessee</b>	<b>lessee number</b>		
			Benji's Delicatessin & Restaur	414.332.7777		
			Baskin Robbins	414.964.3330		
			Zahorick Chiropractic	414.332.2380		
			The Mast Realty Group LLC	414.961.6278		



d.	<b>address</b>	4144 N. Oakland Ave	<b>current use</b>	Vacant dry cleaners		
	<b>tax ID</b>	2390378	<b>Zoning</b>	B-1 Commercial	<b>land assessment 2006</b>	\$114,400
	<b>Business</b>	Carriage Cleaners	<b>Lot area</b>	46' x 140'	<b>building assessment 2006</b>	<u>\$54,900</u>
	<b>Company</b>	Palmetto LLC	<b>building area</b>	67' x 20'	<b>Total assessment</b>	\$169,300
	<b>address</b>	PO Box 11055 Shorewood WI 53211	<b>number of stories</b>	1	<b>equalized value</b>	\$249,411
	<b>Owner</b>	Wendy Wasserman	<b>LLC: ID P037733 Agent Larry L Nifong 2131 S Webster Ave ste 201 Green Bay WI 54301</b>			
	<b>phone</b>		<b>lease</b>	414.961.0668	<b>lessee number</b>	<b>lessee mailing address</b>
			<b>lessee</b>			



e.	<b>address</b>	1806-8 E. Wood Place	<b>current use</b>	12 unit multifamily		
	<b>tax ID</b>	2390377	<b>Zoning</b>	B-1 Commercial	<b>land assessment 2006</b>	\$167,400
	<b>Business</b>		<b>Lot area</b>	90' x 98'	<b>building assessment 2006</b>	<u>\$358,500</u>
	<b>Company</b>	Ronald J Leggio ET AL	<b>building area</b>	44' x 80'	<b>Total assessment</b>	\$525,900
	<b>address</b>	19635 Avondale Dr, Brookfield WI 53045-3726	<b>number of stories</b>	2	<b>equalized value</b>	\$774,750
	<b>Owner</b>	Eastwood Apts 1806 LLC	<b>LLC: ID E034923 Agent Ronald J Leggio 19635 Avondale Drive Brookfield, WI 53045</b>			
	<b>phone</b>		<b>lessee</b>	<b>lessee number</b>	<b>lessee mailing address</b>	



**Community Development Authority  
Priority Development Sites - 2007**

Village of Shorewood  
3930 N. Murray Ave  
Shorewood, WI 53211  
414.847.2700

**7 4081-4093 Oakland**



a.	<b>address</b>	4081 N. Oakland Ave	<b>current use</b>	retail		
	<b>tax ID</b>	2400044	<b>Zoning</b>	B-1 Commercial	<b>land assessment 2006</b>	\$454,300
	<b>Business</b>	Walgreens	<b>Lot area</b>	156' x 208'	<b>building assessment 2006</b>	<u>\$882,400</u>
	<b>Company</b>	Oakland Av Property LP	<b>building area</b>	10,560 sf	<b>Total assessment</b>	\$1,336,700
	<b>address</b>	1552 S. 54th St, West Milwaukee, WI 53214	<b>number of stories</b>	1	<b>equalized value</b>	\$1,969,210
	<b>Owner</b>	Cheryl Inda			<b>lessee</b>	<b>lessee number</b>
	<b>phone</b>				Walgreens Co	<b>lessee mailing address</b>
						300 Wilmot Rd MS-3301, Deerfield IL 60015-4614

b.	<b>address</b>	4093 N. Oakland Ave	<b>current use</b>	retail		
	<b>tax ID</b>	2400045	<b>Zoning</b>	B-1 Commercial	<b>land assessment 2006</b>	\$192,700
	<b>Business</b>	Harry W. Schwartz Book Store	<b>Lot area</b>	156' x 338'	<b>building assessment 2006</b>	<u>\$709,200</u>
	<b>Company</b>	Oakland Av Property LP	<b>building area</b>	7,830 sf	<b>Total assessment</b>	\$901,900
	<b>address</b>	1552 S. 54th St, West Milwaukee, WI 53214	<b>number of stories</b>	1	<b>equalized value</b>	\$1,328,668
	<b>Owner</b>	Cheryl Inda			<b>lessee</b>	<b>lessee number</b>
	<b>phone</b>				Schwartz Bookstore	<b>lessee mailing address</b>
						219 N. Milwaukee St, Milwaukee WI 53202-5818

**8 1800 Olive and 4208-4230 Oakland**



a.	<b>address</b>	4230 N. Oakland	<b>current use</b>	service		
	<b>tax ID</b>	2390309	<b>Zoning</b>	B-2 Mixed Use Residential	<b>land assessment 2006</b>	\$133,000
	<b>Business</b>	UPS	<b>land area</b>	60' x 150'	<b>building assessment 2006</b>	<u>\$76,800</u>
	<b>Company</b>	Frederic M Wein Et Al	<b>building area</b>	2,048 sf	<b>Total assessment</b>	\$209,800
	<b>address</b>	PO Box 17396 Milwaukee WI 53217 (h) 301 W. Dean Rd, Milwaukee WI 53217	<b>number of stories</b>	1	<b>equalized value</b>	\$309,075
	<b>Owner</b>	Frederic Wein			<b>lessee</b>	<b>lessee number</b>
	<b>phone</b>					<b>lessee mailing address</b>

b.	<b>address</b>	4214-16 N. Oakland	<b>current use</b>	Duplex		
	<b>tax ID</b>	2390308	<b>Zoning</b>	B-2 Mixed Use Residential	<b>land assessment 2006</b>	\$96,300
	<b>Business</b>		<b>land area</b>	136' 50'	<b>building assessment 2006</b>	<u>\$119,500</u>
	<b>Company</b>		<b>building area</b>	44' x 28'	<b>Total assessment</b>	\$215,800
	<b>address</b>	1523 E. Lindale Ln, Green Bay WI 54313	<b>number of stories</b>	2	<b>equalized value</b>	\$317,914
	<b>Owner</b>	Scott Fortney			<b>lessee</b>	<b>lessee number</b>
	<b>phone</b>					<b>lessee mailing address</b>



**Community Development Authority  
Priority Development Sites - 2007**

Village of Shorewood  
3930 N. Murray Ave  
Shorewood, WI 53211  
414.847.2700



c. **address** 4208-12 N. Oakland **current use** Mixed use  
**tax ID** 2390307 **Zoning** B-2 Mixed Use Residential **land assessment 2006** \$96,300  
**Business** **land area** 136' x 50' **building assessment 2006** \$207,700  
**Company** **building area** 79' x 35' **Total assessment** \$304,000  
**address** N73 W24346 Ridgewood Rd **number of stories** 2 **equalized value** \$447,849  
 Sussex, WI 53089  
**lessee** **lessee number** **lessee mailing address**  
 Eugene R & W Kaprzak Oakland Glow Salon 414.964.4569 4208 N. Oakland  
**Owner**  
**phone**

d. **address** 1800-8 E. Olive **current use** 12 unit multifamily  
**tax ID** 2390306 **Zoning** B-2 Mixed Use Residential **land assessment 2006** \$114,100  
**Business** **land area** 136x 50' **building assessment 2006** \$439,100  
**Company** Netzow Family Trust **building area** 30 x 130' **Total assessment** \$553,200  
**address** 5069 N. Lake Dr, Whitefish Bay, WI 53217 **number of stories** **equalized value** \$814,968  
  
**Owner** Co owner John E. Rupke Trust  
**phone**

9 **1604-1620 Capitol**



a. **address** 1604 E. Capitol Dr **current use** gas station  
**tax ID** 2400101 **Zoning** B-1 Commercial **land assessment 2006** \$173,800  
**Business** Citgo Gas **land area** 90 x 105' **building assessment 2006** \$157,500  
**Company** Sara LLC **building area** **Total assessment** \$331,300  
**address** 1604 E. Capitol Dr, Shorewood, WI 53211 **number of stories** **equalized value** \$488,067  
 LLC: ID S072987 Agent Syed M Rizvi 1604 W. Capitol Dr Whorewood WI 53211  
**Owner** Syed Rizvi  
**phone**

b. **address** 1620 E. Capitol Dr **current use** post office  
**tax ID** 2400102 **Zoning** B-1 Commercial **land assessment 2006** -  
**Business** US Post Office **land area** 135 x 180' **building assessment 2006** -  
**Company** **building area** 70' x 86' **Total assessment**  
**address** 1620 E. Capitol Dr. Shorewood, WI 53211-1931 **number of stories** 2 **equalized value**  
  
**Owner**  
**phone**



**Community Development Authority  
Priority Development Sites - 2007**

Village of Shorewood  
3930 N. Murray Ave  
Shorewood, WI 53211  
414.847.2700

**10 4000-4008 Morris and 1518-1530 Capitol**

a.	<b>address</b>	4000 N. Morris Blvd	<b>current use</b>	multifamily		
	<b>tax ID</b>	2400357	<b>Zoning</b>	B-3 Mixed Use Commercial	<b>land assessment 2006</b>	\$129,000
	<b>Business</b>		<b>land area</b>	60 x 126'	<b>building assessment 2006</b>	<u>\$476,600</u>
	<b>Company</b>	Neufeld-Kaplan LLC	<b>building area</b>		<b>Total assessment</b>	\$605,600
	<b>address</b>	8750 W. Mill Rd., Milwaukee, WI 53225	<b>number of stories</b>	3	<b>equalized value</b>	\$892,163
	<b>Owner</b>	M & R Neufeld	<b>LLC: ID N026824 Agent Rosalie Neufeld 8750 W. Mill Rd Milwaukee WI 53225</b>			
	<b>phone</b>	414.202.9661				



	<b>address</b>	4008 N. Morris Blvd.	<b>current use</b>	multifamily		
	<b>tax ID</b>	2400356	<b>Zoning</b>	B-3 Mixed Use Commercial	<b>land assessment 2006</b>	\$113,600
	<b>Business</b>		<b>land area</b>	60 x 126'	<b>building assessment 2006</b>	<u>\$474,100</u>
	<b>Company</b>		<b>building area</b>		<b>Total assessment</b>	\$587,700
	<b>address</b>	2729 N. Shepard, Milwaukee WI 53225	<b>number of stories</b>		<b>equalized value</b>	\$865,793
	<b>Owner</b>	John P Bradshaw				
	<b>phone</b>					



c.	<b>address</b>	1518 Capitol Dr	<b>current use</b>	commercial		
	<b>tax ID</b>	2400358	<b>Zoning</b>	B-3 Mixed Use Commercial	<b>land assessment 2006</b>	\$72,200
	<b>Business</b>	Fletcher's Flowers	<b>land area</b>	120 x 40'	<b>building assessment 2006</b>	<u>\$150,800</u>
	<b>Company</b>		<b>building area</b>		<b>Total assessment</b>	\$223,000
	<b>address</b>	4008 N. Morris Blvd, Shorewood, WI 53211	<b>number of stories</b>	1	<b>equalized value</b>	\$328,521
	<b>Owner</b>	Kathleen Fletcher	<b>lessee</b>	Unique Simple Elements	<b>lessee phone</b>	414.332.3996
	<b>phone</b>		<b>lessee</b>	Fletcher's Flowers	<b>lessee mailing address</b>	414.963.9555



**Community Development Authority  
Priority Development Sites - 2007**

Village of Shorewood  
3930 N. Murray Ave  
Shorewood, WI 53211  
414.847.2700

d. **address** 1520 E. Capitol Dr **current use** commercial  
**tax ID** 2400359 **Zoning** B-3 Mixed Use Commercial **land assessment 2006** \$49,200  
**Business** **land area** 120 x 26' **building assessment 2006** \$54,900  
**Company** CAPLAR LLC **building area** **Total assessment** \$104,100  
**address** PO Box 13907 Wauwatosa WI 53213-0907 **number of stories** 1 **equalized value** \$153,359  
**Owner** Nick D'Amato **LLC: ID** C063971 Agent Rappold Ventures LLC 5035 Pheasant Valley Rd Cascade WI 53011; **lessee** **lessee phone** **lessee mailing address**  
**phone** **Rappold Ventures** ID R038797 Agent Wayne H Nick's Barber Shop 414.961.9153 1520 E. Capitol Dr, Shorewood  
 Rappold 6618 romona Ave Wauwatosa WI 53213 Vacant space

e. **address** 1530 E. Capitol Dr. **current use** bank/office  
**tax ID** 2400360 **Zoning** B-3 Mixed Use Commercial **land assessment 2006** \$132,300  
**Business** Wells Fargo Bank, 414.961.7201 **land area** 52 x 120' **building assessment 2006** \$210,200  
**Company** Wells Fargo Bank WI N.A. **building area** **Total assessment** \$342,500  
**address** PO Box 4900, Scottsdale AZ 85261-4900 **number of stories** 1 **equalized value** \$504,567  
**Owner** **lessee** **lessee phone** **lessee mailing address**  
**phone** Wells Fargo Capitol Dr PO Box 63931 San Francisco, CA 94163

11 **4201 Oakland**



**address** 4201 N. Oakland Ave **current use** bank/office  
**tax ID** 2409994001 **Zoning** B-3 Mixed Use Commercial **land assessment 2006** \$252,600  
**Business** TCF Bank, 414.963.1800 **land area** 120 x 132' **building assessment 2006** \$307,400  
**Company** TCF Bank WI FSB **building area** 2,304 sf **Total assessment** \$560,000  
**address** 500 W. Brown Deer Rd, Milwaukee WI 53217-8096 **number of stories** 1 **equalized value** \$824,985  
**Owner** c/o Richard Thiermann **lessee** **lessee phone** **lessee mailing address**  
**phone**



**Community Development Authority  
Priority Development Sites - 2007**

Village of Shorewood  
3930 N. Murray Ave  
Shorewood, WI 53211  
414.847.2700

12 3575 Oakland



<b>address</b>	3575 N. Oakland Ave	<b>current use</b>	office		
<b>tax ID</b>	2751181	<b>Zoning</b>	B-1 Commercial	<b>land assessment 2006</b>	\$287,200
<b>Business</b>		<b>land area</b>	118 x 160'	<b>building assessment 2006</b>	<u>\$2,045,000</u>
<b>Company</b>	Lakewood Financial Svcs LLC	<b>building area</b>		<b>Total assessment</b>	\$2,332,200
<b>address</b>	809 S. 60th, Ste 203, West Allis, WI 53214	<b>number of stories</b>	5	<b>equalized value</b>	\$3,435,769
<b>Owner</b>	Charles Stewart			<b>lessee</b>	<b>lessee phone</b> <b>lessee mailing address</b>
<b>phone</b>					
<b>status</b>	Winter 2006-07 interior rehab				

13 4300 Oakland



<b>address</b>	4300 N. Oakland Ave	<b>current use</b>	drycleaners		
<b>tax ID</b>	2390291	<b>Zoning</b>	B-2 Mixed Use Residential	<b>land assessment 2006</b>	\$167,800
<b>Business</b>	Vacant Queensway Drycleaners	<b>land area</b>	88 x 100'	<b>building assessment 2006</b>	\$59,600
<b>Company</b>		<b>building area</b>	40' x 60'	<b>Total assessment</b>	\$227,400
<b>address</b>	855 E. Silver Spring Dr. Whitefish Bay, WI 53217	<b>number of stories</b>	1	<b>equalized value</b>	\$335,003
<b>Owner</b>	Donald A. Carlson			<b>lessee</b>	<b>lessee phone</b> <b>lessee mailing address</b>
<b>phone</b>					

14 4514 Oakland



<b>address</b>	4514 N. Oakland Ave	<b>current use</b>	gas station		
<b>tax ID</b>	2370233	<b>Zoning</b>	B-1 Commercial	<b>land assessment 2006</b>	\$241,200
<b>Business</b>	Mobil Gas Station	<b>land area</b>	125 x 125'	<b>building assessment 2006</b>	<u>\$153,100</u>
<b>Company</b>	Broadacre Shorewood LLC	<b>building area</b>		<b>Total assessment</b>	\$394,300
<b>address</b>	297 Latrobe Ave, Northfield IL 60093	<b>number of stories</b>		<b>equalized value</b>	\$580,878
<b>Owner</b>	William H. Laev	<b>LLC: ID B055473 Agent CSC-Lawyers Incorporating Service Co 25 W. Main St Madison WI 53703</b>		<b>Property Management</b>	Exon Mobile, Lakeside Oil Co. 555 W. Brown Deer Rd. Milwaukee, WI 53211
<b>phone</b>				<b>lessee</b>	<b>lessee phone</b> <b>lessee mailing address</b>
				Matt Rech	



## Community Development Authority Priority Development Sites - 2007

Village of Shorewood  
3930 N. Murray Ave  
Shorewood, WI 53211  
414.847.2700

**15 1700-1712 Capitol**



a.	<b>address</b>	1700 E. Capitol Dr	<b>current use</b>	commercial		
	<b>tax ID</b>	2400020	<b>Zoning</b>	B-1 Commercial	<b>land assessment 2006</b>	\$101,200
	<b>Business</b>		<b>land area</b>	42 x 120'	<b>building assessment 2006</b>	<u>\$166,300</u>
	<b>Company address</b>	Mercen Living Trust 4244 N. Olson Ave, Shorewood WI 53211	<b>building area</b>		<b>Total assessment</b>	\$267,500
			<b>number of stories</b>	4	<b>equalized value</b>	\$394,078
	<b>Owner</b>	Martin & Shirley Mercen			<b>lessee</b>	<b>lessee phone</b>
	<b>phone</b>				Mike Crivello Camera	414.332.1550
						<b>lessee mailing address</b>
						1700 E. Capitol Dr

b.	<b>address</b>	1706 E. Capitol Dr	<b>current use</b>	commercial		
	<b>tax ID</b>	2400021	<b>Zoning</b>	B-1 Commercial	<b>land assessment 2006</b>	\$100,000
	<b>Business</b>		<b>land area</b>	45 x 120'	<b>building assessment 2006</b>	\$120,000
	<b>Company address</b>	2943 N. Hackett Av, Milwaukee WI 53211	<b>building area</b>		<b>Total assessment</b>	\$220,000
			<b>number of stories</b>		<b>equalized value</b>	\$324,101
	<b>Owner</b>	Keith & Mary Lou Johnson			<b>lessee</b>	<b>lessee phone</b>
	<b>phone</b>				Brighter Concepts	414.332.9050
						<b>lessee mailing address</b>
						1706 E. Capitol Dr

c.	<b>address</b>	1712 E. Capitol Dr	<b>current use</b>	commercial		
	<b>tax ID</b>	2400022	<b>Zoning</b>	B-1 Commercial	<b>land assessment 2006</b>	\$84,000
	<b>Business</b>		<b>land area</b>	42 x 120'	<b>building assessment 2006</b>	<u>\$233,100</u>
	<b>Company address</b>	9524 N. Wakefield CT, Bayside, WI 53217	<b>building area</b>		<b>Total assessment</b>	\$317,100
			<b>number of stories</b>		<b>equalized value</b>	\$467,148
	<b>Owner</b>	Michael Yerukhimovich, co owner Klara Fleysh			<b>lessee</b>	<b>lessee phone</b>
	<b>phone</b>				DDS	414.963.0950
					Salzstein Accounting/Tax Sen	414.332.3122
						<b>lessee mailing address</b>
						1712 E. Capitol Dr

**16 3970 Oakland, 3975 Cramer**



a.	<b>address</b>	3970 N. Oakland Ave	<b>current use</b>	office building		
	<b>tax ID</b>	2760749006	<b>Zoning</b>	B-1 Commercial	<b>land assessment 2006</b>	\$782,700
	<b>Business</b>	North Shore Bank Building	<b>land area</b>	61,261 sf (approx 440 x 192')	<b>building assessment 2006</b>	<u>\$2,167,300</u>
	<b>Company address</b>	WI Robinson family LP 2725 W. Highland Blvd. Ste #219 Milwaukee, WI 53208	<b>building area</b>		<b>Total assessment</b>	\$2,950,000
			<b>number of stories</b>	8	<b>equalized value</b>	\$4,345,905
	<b>Owner</b>	Geraldine Robinson, co owner JJ&R Enterprises			<b>lessee</b>	<b>lessee phone</b>
	<b>phone</b>					<b>lessee mailing address</b>

b.	<b>address</b>	3975 N. Cramer St	<b>current use</b>	18 unit multifamily		
	<b>tax ID</b>	2760733	<b>Zoning</b>	B-1 Commercial	<b>land assessment 2006</b>	\$161,100
	<b>Business</b>		<b>land area</b>	121 x 80'	<b>building assessment 2006</b>	<u>\$791,300</u>
	<b>Company address</b>	PO Box 510675, Milwaukee WI 53203	<b>building area</b>		<b>Total assessment</b>	\$952,400
			<b>number of stories</b>	3	<b>equalized value</b>	\$1,403,064
	<b>Owner</b>	Thomas J Kuesel, co owner Key Management Inc			<b>Property Management</b>	
	<b>phone</b>				<b>lessee</b>	<b>lessee phone</b>
					Over 20 tenants	<b>lessee mailing address</b>



## Community Development Authority Priority Development Sites - 2007

Village of Shorewood  
3930 N. Murray Ave  
Shorewood, WI 53211  
414.847.2700

### 17 3500 Oakland



<p><b>address</b> 3506 N. Oakland Ave <b>tax ID</b> 2760555001 <b>Business address</b> Sherwin Williams paint store <b>Company address</b> 3510 Oakland LLC 1522 N. Prospect Ave Milwaukee WI 53202</p> <p><b>Owner</b> G E Tojek, co owner Dimitropoulos <b>phone</b></p>	<p><b>current use</b> commercial <b>Zoning</b> B-1 Commercial <b>land area</b> 113 x 120' <b>building area</b> 140' x 88' <b>number of stories</b> 2</p>	<p><b>land assessment 2006</b> \$258,000 <b>building assessment 2006</b> <u>\$757,200</u> <b>Total assessment</b> \$1,015,200 <b>equalized value</b> \$1,495,580</p> <p><b>Property Management</b> Lease space through Lesselmann 262.241.0777</p> <p><b>lessee</b> Anteka Family Pharmacy Sherwin Williams Co University Bible Fellowship Piano Milwaukee Graduates Assistants Youth Independence Custom Solids LADA Driving School Jewish Reach, Inc General Dentistry Physical Awareness Massage</p> <p><b>lessee phone</b> 3510 N. Oakland 3510 N. Oakland 3510 N. Oakland, Ste 207 3510 N. Oakland, Ste 212-2 3510 N. Oakland, Ste 209 3510 N. Oakland, Ste 3510 N. Oakland, Ste 205 3510 N. Oakland, Ste 204 3510 N. Oakland, Ste 203 3511 N. Oakland, Ste 210 3511 N. Oakland, Ste 206</p>
--	--	---



### 18 1305 Capitol



<p><b>address</b> 1305 E. Capitol Dr <b>tax ID</b> 2758999001 <b>Business address</b> Bakers Square Konstantine Dimitropoulous Trust 3207 S. Ridgecrest Ct, New Berlin WI 53151</p> <p><b>Owner</b> Konstantine Dimitropoulous <b>phone</b></p>	<p><b>current use</b> restaurant <b>Zoning</b> B-3 Mixed Use Commercial <b>land area</b> 238 x 480 x 386' <b>building area</b> 86' x 64' <b>number of stories</b> 1</p>	<p><b>land assessment 2006</b> \$474,600 <b>building assessment 2006</b> <u>\$371,800</u> <b>Total assessment</b> \$846,400 <b>equalized value</b> \$1,246,906</p> <p><b>Property Management</b></p> <p><b>lessee</b> Baker's Square #195 <b>lessee phone</b> <b>lessee mailing address</b> PO Box 16601 Denver, CO 80216</p>
---	---	---

### 19 1330 Capitol

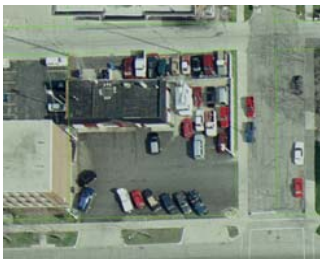

<p><b>address</b> 1330 E. Capitol Dr <b>tax ID</b> 2409983 <b>Business address</b> Shorewood Auto Repair <b>Company address</b> EKL Investments, Inc 1330 E. Capitol Dr, Shorewood, WI 53211</p> <p><b>Owner</b> co owner Keith Lasanke <b>phone</b></p>	<p><b>current use</b> Auto repair <b>Zoning</b> B-3 Mixed Use Commercial <b>land area</b> 120 x 116' <b>building area</b> <b>number of stories</b> LLC: ID E027853 Agend Keith Lasanke 1330 E. Capitol Dr Whorewood, WI 53211</p>	<p><b>land assessment 2006</b> \$231,100 <b>building assessment 2006</b> <u>\$82,600</u> <b>Total assessment</b> \$313,700 <b>equalized value</b> \$462,139.07</p> <p><b>Property Management</b></p> <p><b>lessee</b> Shorewood Auto Repair <b>lessee phone</b> 414.963.0549 <b>lessee mailing address</b> 1330 E. Capitol Dr, Shorewood WI 53211</p>
--	---	---



**Community Development Authority  
Priority Development Sites - 2007**

Village of Shorewood  
3930 N. Murray Ave  
Shorewood, WI 53211  
414.847.2700

20 3532-3592 Oakland



<b>a.</b>						
<b>address</b>	3592 N. Oakland Ave	<b>current use</b>	take out restaurant			
<b>tax ID</b>	2760170	<b>Zoning</b>	B-2 Mixed Use Residential	<b>land assessment 2006</b>	\$162,500	
<b>Business</b>	Fellicci's Mama Mia	<b>land area</b>	120 x 88'	<b>building assessment 2006</b>	<u>\$163,000</u>	
<b>Company address</b>	DOR PROP LLC 6425 Odana Rd, Madison WI 53719	<b>building area</b>		<b>Total assessment</b>	\$325,500	
		<b>number of stories</b>	1	<b>equalized value</b>	\$479,523	
<b>Owner</b>	Robert Reuschlein			<b>Property Management</b>		
<b>phone</b>		<b>lessee</b>	Fellicci's Mama Mia	<b>lessee phone</b>		<b>lessee mailing address</b> 3592 N. Oakland Ave Shorewood WI 53211
<b>b.</b>						
<b>address</b>	3582 N. Oakland Ave	<b>current use</b>	multifamily			
<b>tax ID</b>	2760169	<b>Zoning</b>	B-2 Mixed Use Residential	<b>land assessment 2006</b>	\$101,900	
<b>Business</b>		<b>land area</b>	120 x 56'	<b>building assessment 2006</b>	<u>\$222,100</u>	
<b>Company address</b>	1545 W. Cedar Ln Milwaukee, WI 53217	<b>building area</b>		<b>Total assessment</b>	\$324,000	
		<b>number of stories</b>	2	<b>equalized value</b>	\$477,313	
<b>Owner</b>	Richard C GAD Trustee			<b>Property Management</b>		
<b>phone</b>		<b>lessee</b>		<b>lessee phone</b>		<b>lessee mailing address</b>
<b>c.</b>						
<b>address</b>	3576 N. Oakland Ave	<b>current use</b>	multifamily			
<b>tax ID</b>	2760563	<b>Zoning</b>	B-2 Mixed Use Residential	<b>land assessment 2006</b>	\$89,900	
<b>Business</b>		<b>land area</b>	117 x 68'	<b>building assessment 2006</b>	<u>\$222,100</u>	
<b>Company address</b>	1007 N. Cass St, Milwaukee WI 53202	<b>building area</b>		<b>Total assessment</b>	\$312,000	
		<b>number of stories</b>	2	<b>equalized value</b>	\$459,635	
<b>Owner</b>	Shirley Friedman Trustee Et Al, co owner The Shoreline Co			<b>Property Management</b>		
<b>phone</b>		<b>lessee</b>		<b>lessee phone</b>		<b>lessee mailing address</b>
<b>d.</b>						
<b>address</b>	3568 N. Oakland Ave	<b>current use</b>	multifamily			
<b>tax ID</b>	2760562	<b>Zoning</b>	B-2 Mixed Use Residential	<b>land assessment 2006</b>	\$123,400	
<b>Business</b>		<b>land area</b>	117 x 68'	<b>building assessment 2006</b>	<u>\$203,100</u>	
<b>Company address</b>	St. James Estate LLC PO Box 252, Marion WI 54950	<b>building area</b>		<b>Total assessment</b>	\$326,500	
		<b>number of stories</b>	2	<b>equalized value</b>	\$480,996	
<b>Owner</b>	Steve Wolff			<b>Property Management</b>		
<b>phone</b>	715.754.3333	<b>lessee</b>		<b>lessee phone</b>		<b>lessee mailing address</b>
<b>e.</b>						
<b>address</b>	3560 N. Oakland Ave	<b>current use</b>	multifamily			
<b>tax ID</b>	2760541	<b>Zoning</b>	B-2 Mixed Use Residential	<b>land assessment 2006</b>	\$88,100	
<b>Business</b>		<b>land area</b>	117 x 48'	<b>building assessment 2006</b>	<u>\$338,000</u>	
<b>Company address</b>	3537 N. Cramer St. Shorewood, WI 53211	<b>building area</b>		<b>Total assessment</b>	\$426,100	
		<b>number of stories</b>	2	<b>equalized value</b>	\$627,725	
<b>Owner</b>	Kennith Swoboda			<b>Property Management</b>		
<b>phone</b>		<b>lessee</b>		<b>lessee phone</b>		<b>lessee mailing address</b>



**Community Development Authority  
Priority Development Sites - 2007**

Village of Shorewood  
3930 N. Murray Ave  
Shorewood, WI 53211  
414.847.2700

f.	<b>address</b>	3552 N. Oakland Ave	<b>current use</b>	multifamily		
	<b>tax ID</b>	2760560	<b>Zoning</b>	B-2 Mixed Use Residential	<b>land assessment 2006</b>	\$88,100
	<b>Business</b>		<b>land area</b>	117 x 48'	<b>building assessment 2006</b>	<u>\$258,900</u>
	<b>Company</b>	St. James Estate LLC	<b>building area</b>		<b>Total assessment</b>	\$347,000
	<b>address</b>	PO Box 252, Marion WI 54950	<b>number of stories</b>	2	<b>equalized value</b>	\$511,196
	<b>Owner</b>	Milan Torbica: 2824 E. Newberry Blvd, Milwaukee WI 53211			<b>Property Management</b>	
	<b>phone</b>				<b>lessee</b>	<b>lessee phone</b> <b>lessee mailing address</b>
<hr/>						
g.	<b>address</b>	3546 N. Oakland Ave	<b>current use</b>	multifamily		
	<b>tax ID</b>	2760559	<b>Zoning</b>	B-2 Mixed Use Residential	<b>land assessment 2006</b>	\$88,100
	<b>Business</b>		<b>land area</b>	117 x 48'	<b>building assessment 2006</b>	<u>\$255,000</u>
	<b>Company</b>	3546 Company	<b>building area</b>		<b>Total assessment</b>	\$343,100
	<b>address</b>	1840 N. Farwell Ave #201, Milwaukee WI 53202	<b>number of stories</b>	2	<b>equalized value</b>	\$505,451
	<b>Owner</b>	c/o Michael McCilone			<b>Property Management</b>	
	<b>phone</b>				<b>lessee</b>	<b>lessee phone</b> <b>lessee mailing address</b>
<hr/>						
h.	<b>address</b>	3540 N. Oakland Ave	<b>current use</b>	multifamily		
	<b>tax ID</b>	2760558	<b>Zoning</b>	B-2 Mixed Use Residential	<b>land assessment 2006</b>	\$88,100
	<b>Business</b>		<b>land area</b>	117 x 48'	<b>building assessment 2006</b>	<u>\$235,400</u>
	<b>Company</b>	Milanco Properties LLC	<b>building area</b>		<b>Total assessment</b>	\$323,500
	<b>address</b>	3540 N. Oakland Ave, Shorewood WI 53211	<b>number of stories</b>	2	<b>equalized value</b>	\$476,576
	<b>Owner</b>	Michael Harrington: 4869 N. Ardmore Ave, Whitefish Bay WI 53217		LLC ID M0505957 Agent Mark J Schraith 3540 N. Oakland Ave Shorewood WI 53211	<b>Property Management</b>	
	<b>phone</b>				<b>lessee</b>	<b>lessee phone</b> <b>lessee mailing address</b>
<hr/>						
i.	<b>address</b>	3532 N. Oakland Ave	<b>current use</b>	multifamily		
	<b>tax ID</b>	2760557	<b>Zoning</b>	B-2 Mixed Use Residential	<b>land assessment 2006</b>	\$88,100
	<b>Business</b>		<b>land area</b>	117 x 48'	<b>building assessment 2006</b>	<u>\$263,100</u>
	<b>Company</b>		<b>building area</b>		<b>Total assessment</b>	\$351,200
	<b>address</b>	3524 N. Oakland Ave Shorewood, WI 53211	<b>number of stories</b>	2	<b>equalized value</b>	\$517,384
	<b>Owner</b>	William Ho			<b>Property Management</b>	
	<b>phone</b>				<b>lessee</b>	<b>lessee phone</b> <b>lessee mailing address</b>